

TECHNICAL DATA SHEET

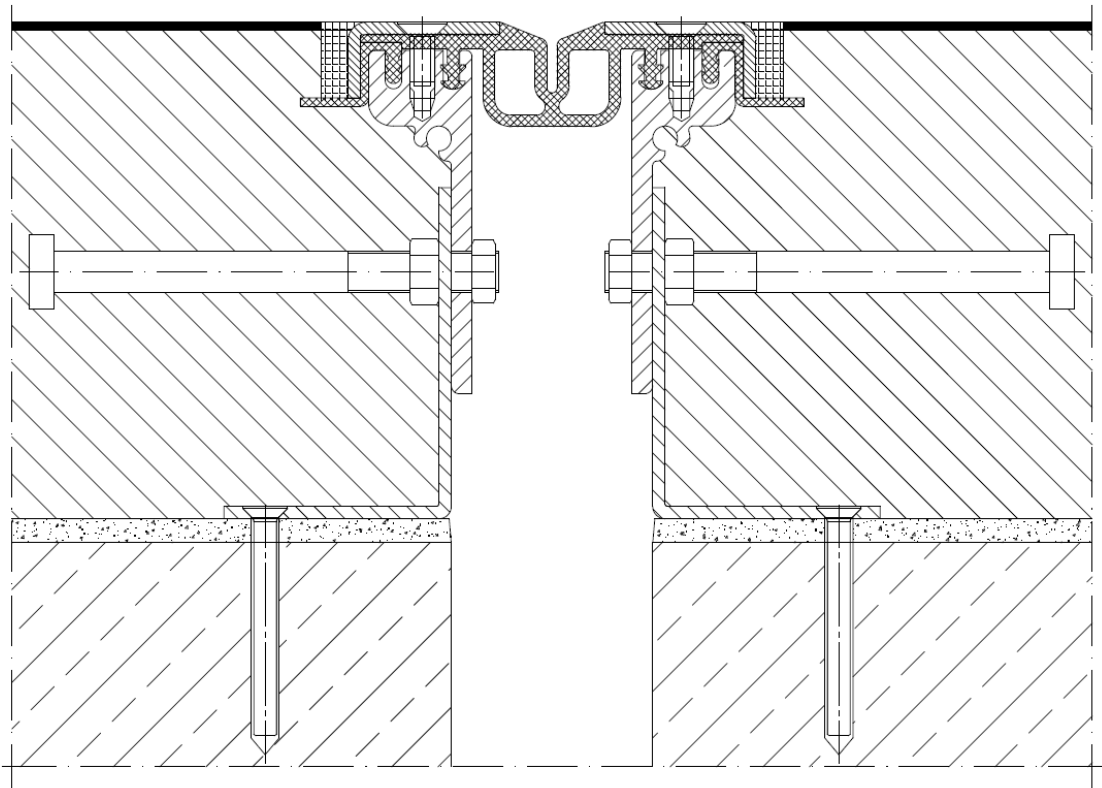

Watertight expansion joints for car park grove applications. Designers enjoy the system for reliability and the small size of the visible element aligned with the parking floor surface. High resistance to trac and loads. Joint is anchored tight and the groove is filled with resin grout. Application of flexible material on joint rims makes the properly installed cover virtually indestructible. The removable cover allows for elastomer replacement in case of mechanical damage. This system has proven its qualities at numerous parking across Europe. In case of groove high, we use Conecto GA on upper mounting bracket (angles with pulling rods) Conecto GA joint also comes in a corner model

| Conecto PARK GA | Visible element [mm] | Gap width [mm] | Base width [mm] | Installation height [mm] | Material type | Maximum load [kN] | Horizontal/Vertical compensation [mm] |
|-----------------|----------------------|----------------|-----------------|-------------------------------|--------------------------------|-------------------|---------------------------------------|
| GA 43.10 | 89 | max 65 | 214 | 100, 150, 200 250, 300, CV | aluminium EPDM/PVC steel | 600 | 20 (± 10) 20 (± 10) |
| GA 50.20 | 97 | max 77 | 222 | 100, 150, 200 250, 300, CV | aluminium PVC, steel | 600 | 40 (± 20) 40 (± 20) |
| GA 63.30 | 109 | max 86 | 235 | 100, 150, 200 250, 300, CV | aluminium PVC, steel | 300 | 60 (± 30) 60 (± 30) |
| GA 88.45 | 134 | max 111 | 260 | 100, 150, 200 250, 300, CV | aluminium PVC, steel | 300 | 90 (± 45) 90 (± 45) |

CV - corner version

Max height till 300mm