

I D E A
project
product



 **conecto**
profiles

CONTENTS EXPANSION JOINTS:

1. FLOOR JOINTS
 - a. Conecto ALU
 - b. Conecto ELASTO
2. CAR PARK FLOOR PROFILES
 - a. Conecto CS
3. CAR PARK WATERTIGHT JOINTS
 - a. Conecto PARK GA
 - b. Conecto PARK SL 190
 - c. Conecto PARK SL 210
4. WALL AND CEILING JOINTS
 - a. Conecto WA
 - b. Conecto JW

I D E A
project
product





Conecto joints are manufactured of a specially engineered aluminum to load deformation resistance. Joints are formed so as to allow easy cleaning and accumulate no contamination. Joints are used for heavy traffic facilities such as shopping malls, office buildings, hotels or schools. Joints withstand up to 100kN loads, depending on the wheel size and effective pressure area. High resistance and aesthetic look are the main advantages of the joint.

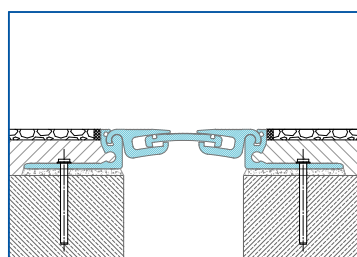

groove version

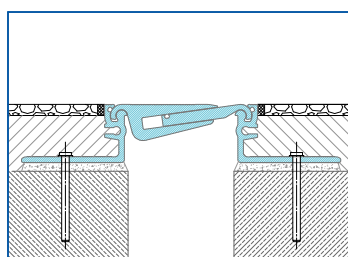

groove version

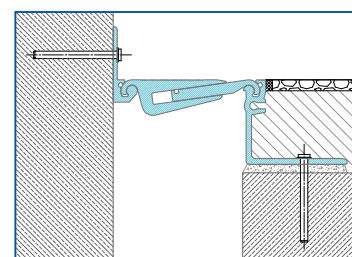

corner version

Conecto ALU	Visible element [mm]	Gap width [mm]	Base width [mm]	Installation height [mm]	Material type	Maximum load [kN]	Horizontal/Vertical compensation [mm]
AL.38.10	38	max 30	162	14, 32, 42	aluminium	30	20 (± 10)
AL.78.10	78	max 50	194	N, 15, 22, 30, 42, 52, 62, 77, 87, CV	aluminium	100	20 (± 10) 32 (± 16)
AL.110.15	110	max 75	225	N, 15, 22, 30, 42, 52, 62, 77, 87, CV	aluminium	100	32 (± 16) 46 (± 23)
AL.125.20	125	max 90	230	N, 15, 22, 30, 42, 52, 62, 77, 87, CV	aluminium	70	40 (± 20) 50 (± 25)
AL.130.21	130	max 95	255	N, 15, 22, 30, 42, 52, 62, 77, 87, CV	aluminium	100	42 (± 21) 54 (± 27)
AL.165.30	165	max 130	284	N, 15, 22, 30, 42, 52, 62, 77, 87, CV	aluminium	70	60 (± 30) 62 (± 31)

N - cover version, CV - corner version

In any case of N version gap could be bigger

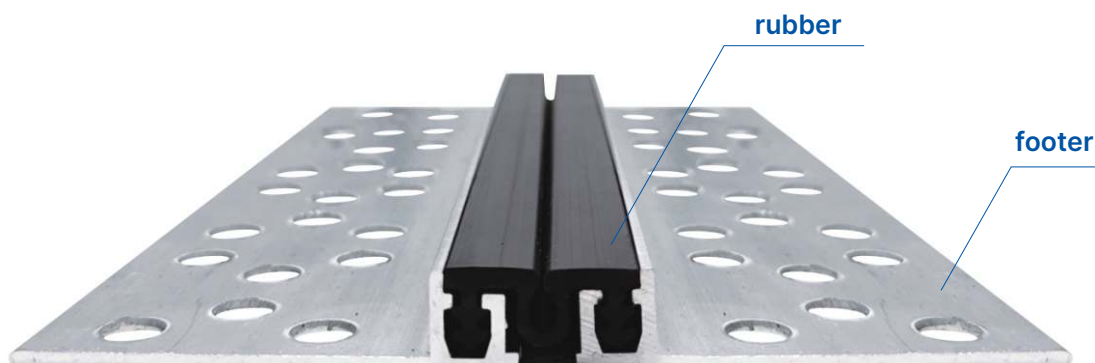

ELASTOMER TYPES

10 colors of rubber



EI 30.06



EI 50.08



EI 65.10



Expansion joint consist of aluminum clamps connected by an elastomer rubber. The elastomer component is made of modified PVC for better durability resistance to UV and aggressive chemicals. Confined cover is a significant advantage of the system. With a small minimum installation height, the system can be used without grooving for 3 mm PVC carpets, 5 mm textile carpets, or tile slabs. Joints perfectly suit as flush mounted floor, wall and ceiling applications.

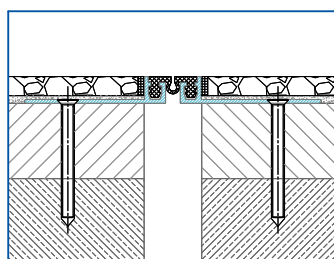

groove version

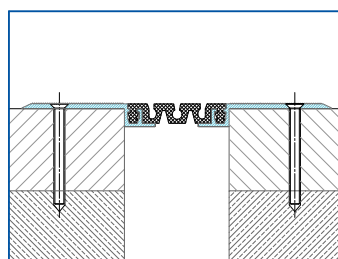

cover version

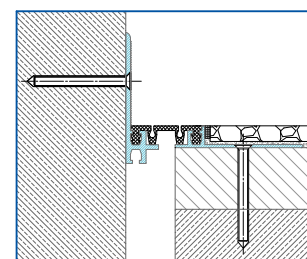

corner version

Conecto ELASTO	Visible element [mm]	Gap width [mm]	Base width [mm]	Installation height [mm]	Material type	Maximum load [kN]	Horizontal/Vertical compensation [mm]
EL. 30.6	30	30	150	N, 5, 7, 10, 12 14, 20, 30 50, 60, 70, CV	aluminium modified PVC	30	12 (± 6) 12 (± 6)
EL.50.8	50	50	175	N, 5, 7, 10, 12 14, 20, 30 50, 60, 70, CV	aluminium modified PVC	30	16 (± 8) 16 (± 8)
EL.65.10	65	65	185	N, 5, 7, 10, 12 14, 20, 30 50, 60, 70, CV	aluminium modified PVC	30	20 (± 10) 20 (± 10)

N - cover version, CV - corner version



Cs is a cover profile. Profile is designed for parking lots and inside usage. It conveys the vehicle traffic efficiently. Can be also use on walls. The profiles particularly suit applications where affordable solutions are required and where there are no upright deformations induced by slab curling.

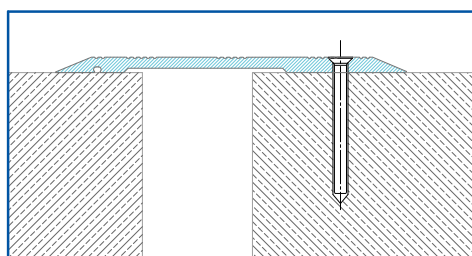

CS one side holes

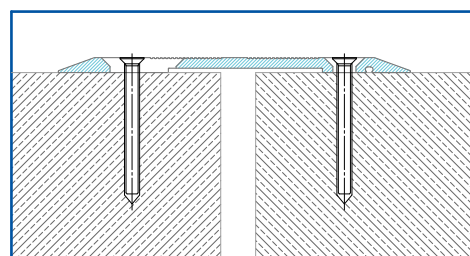

CS bilateral holes

Conecto CS	Visible element [mm]	Gap width [mm]	Installation height [mm]	Material type	Maximum load [kN]	Horizontal compensation [mm]
CS 120 one side holes	120	max 15	5	natural aluminium	60	± 10
CS 160 one side holes	160	max 25	7	natural aluminium	60	± 30
CS 260 one side holes	260	max 80	7	natural aluminium	45	± 65



Watertight expansion joints for car park groove applications. Designers enjoy the system for reliability and the small size of the visible element aligned with the parking floor surface. High resistance to traction and loads. Joint is anchored tight and the groove is filled with resin grout. Application of flexible material on joint rims makes the properly installed cover virtually indestructible. The removable cover allows for elastomer replacement in case of mechanical damage. This system has proven its qualities at numerous parking across Europe. In case of groove high, we use Conecto GA on upper mounting bracket (angles with pulling rods) Conecto GA joint also comes in a corner model and model with long rubber to connect with waterproofing membrane.

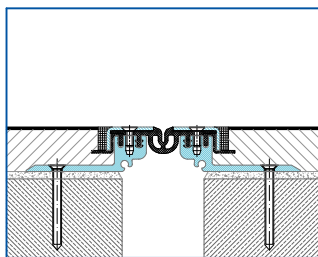

groove version

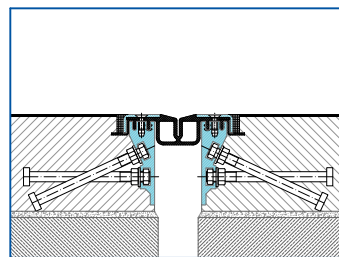

groove high

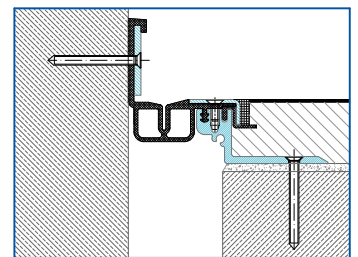

corner version

Conecto PARK GA	Visible element [mm]	Gap width [mm]	Base width [mm]	Installation height [mm]	Material type	Maximum load [kN]	Horizontal/Vertical compensation [mm]
GA 43.10	89	max 65	214	25, 35, 45, 55 70, 90 100-200, CV	aluminium EPDM/PVC steel	600	20 (± 10) 20 (± 10)
GA 50.20	97	max 77	222	25, 35, 45, 55 70, 90 100-200, CV	aluminium PVC, steel	600	40 (± 20) 40 (± 20)
GA 63.30	109	max 86	235	25, 35, 45, 55 70, 90 100-200, CV	aluminium PVC, steel	300	60 (± 30) 60 (± 30)
GA 88.45	134	max 111	260	25, 35, 45, 55 70, 90 100-200, CV	aluminium PVC, steel	300	90 (± 45) 90 (± 45)

CV - corner version
Max height till 300mm



This is an excellent watertight joint proofing system made of highly modified PVC, and overlaps made of aluminum, stainless steel or galvanized steel. Covers can be installed directly onto the reinforced concrete slab or to the concrete overlay layer. We can also offer solutions that can be easily employed from 20 mm to 70 mm gap. Joint perfectly compensates construction movements, horizontal up to 30 mm and vertical up to 20 mm. This solution is recommended when concrete top floor is too thin for groove or when no grooves were provided during concreting. The profile can be installed in the overlapping or aligned version. Elastomer is glued to the surface using special activators, primers and renowned companies' adhesives designed in lab conditions. This solution guarantees watertight and solid connection between elastomer and concrete. Elastomer is also protected by aluminium metal to increase adhesion and protects elastomer from mechanical damage during exploitation. No expansion bolts are required for the joint's installation, which allows it to be installed near the expansion edge without damaging it.

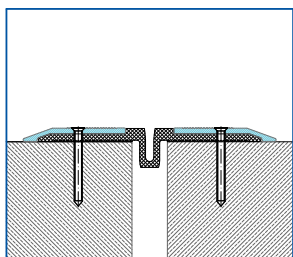

SL 190.30 N

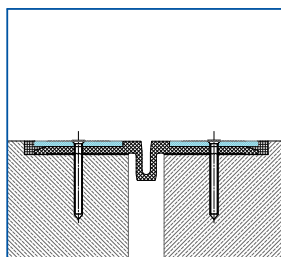

SL 190.30 W

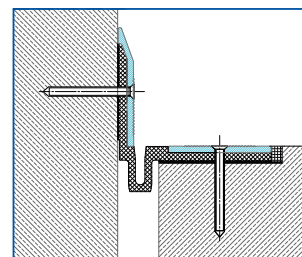

SL 190.30 CV

Conecto PARK SL	Visible element [mm]	Gap width [mm]	Method of installation	Installation height [mm]	Material type	Maximum load [kN]	Horizontal/Vertical compensation [mm]
SL 190.30 N	215	Max 30	cover	10	aluminium PVC	600	40 (± 20) 30 (± 15)
SL 190.30 W	190	Max 30	groove	10	aluminium PVC	600	40 (± 20) 30 (± 15)
SL 190.30CV	124	Max 30	corner	10	aluminium PVC	600	40 (± 20) 30 (± 15)



The system is highly appreciated by the designers for aesthetic look, easy installation. Valued by and investors for eciency, reliability as well as aordable price. Because of long term warranty, our system became sought solution for new facilities, especially for parking places requiring immediate reconstruction. In case of where heat insulation and concrete overlay are required, for example parking places located above trade area, it is possible to use an additional tight membrane in floor slab insulation. Joint has successfully undergone a variety of aging resistance tests proving durability and eectiveness. The system is resistant to aggressive chemicals (like gasoline, diesel fuel, oils, lubricants), UV rays and external conditions. Joint meets the class E fire resistance requirements in accordance with PN-EN 13501-1 standard, which requires that products are capable of resisting - for a short period of time - influence of a small flame without considerably spreading it.

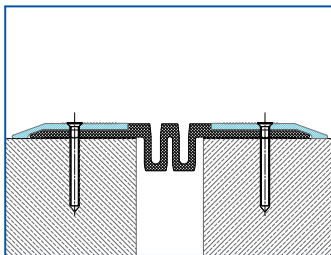

SL 210.50 N

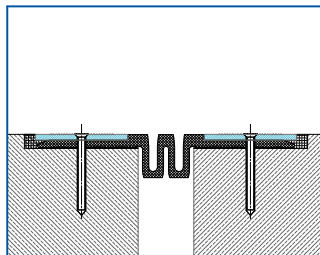

SL 210.50 W

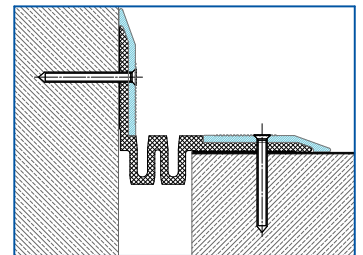

SL 210.50 CV

Conecto PARK SL	Visible element [mm]	Gap width [mm]	Method of installation	Installation height [mm]	Material type	Maximum load [kN]	Horizontal/Vertical compensation [mm]
SL 210.50 N	235	Max 50	cover	10	aluminium PVC	450	60 (± 30) 40 (± 20)
SL 210.50 W	210	Max 50	groove	10	aluminium PVC	450	60 (± 30) 40 (± 20)
SL 210.50 CV	145	Max 50	corner	10	aluminium PVC	450	60 (± 30) 40 (± 20)

We have also SL230.70 version N, W, CV for max gap 70mm and max movements +45mm and +/-20mm



Wall and ceiling expansion joints cover has been developed for wide joints. It is an aesthetic solution that efficiently compensates large deformations. Lateral components are made of aluminum and the compensator is made of a composite slab. This joint can be fitted easily to nearly any substrate and it is available as a cover or flush. This allows the profile to be implemented in any kind of walls and ceilings finishing. Joint is available in RAL 9006.

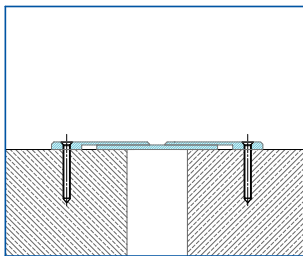

cover floor version

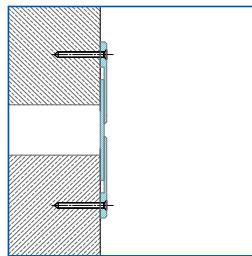

cover wall version

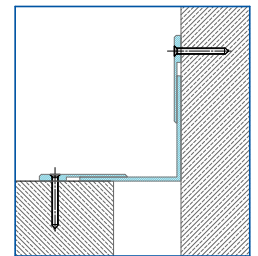

corner version

Conecto WA	Visible element [mm]	Gap width [mm]	Method of installation	Installation height [mm]	Material type	Color	Horizontal/Vertical compensation [mm]
WA 140	140	max 40	cover	5	aluminium, composite	RAL 9006	±10
WA 160	160	max 60	cover	5	aluminium, composite	RAL 9006	±20
WA 210	210	max 100	cover	5	aluminium, composite	RAL 9006	±20
WA 260	260	max 150	cover	5	aluminium, composite	RAL 9006	±20
WA 310	310	max 200	cover	5	aluminium, composite	RAL 9006	±20

Types of clips:

S - width 15-35 mm

M - width 35-80 mm

L - width 70-120 mm

Aesthetic clip-mounted expansion joint cover. The cover made of anodized aluminum is mainly used to cover a gap on wall and ceiling seams ranging from 2 to 15 cm width in places where incombustible materials usage is required. The slim surface element makes it very popular in places where cover profiles should not be too exposed. The installation is exceptionally quick and easy with metal flexiclips.

ADVANTAGES

- installation is possible after plasters are completed
- can be painted in the wall's color
- possibility do adjust clips to joint width

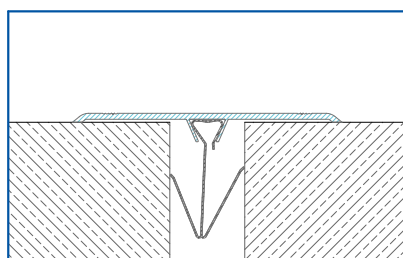
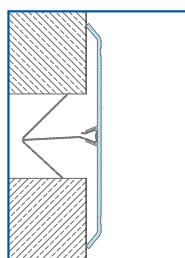
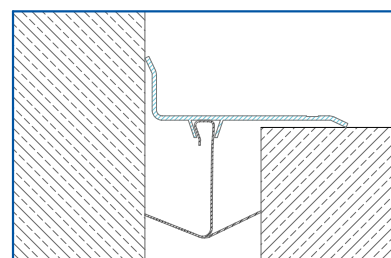
cover floor version

cover wall version

corner version

Conecto JW	Visible element [mm]	Gap width [mm]	Method of installation	Material type	Color
JW 50	50	max 30	cover	aluminium / PVC	anode
JW 70	70	max 50	cover	aluminium / PVC	anode
JW 90	90	max 70	cover	aluminium / PVC	anode
JW 120	120	max 100	cover	aluminium	anode
JW 140	140	max 120	cover	aluminium	anode



CONECTO PROFILES Sp. z o.o.

ul. Przemysłowa 39

61-541 Poznań, Poland

tel. +48 882 180 182

e-mail: damian@conecto-profiles.com

I D E A
project
product

www.conecto-profiles.com